

EC Single Inlet Fans

Small voltage controlled EC centrifugal fans



KEY FEATURES

- Ecodesign ErP 2015 compliant
- Compact size direct drive fans
- EC high efficiency motor
- Engineered for significant benefits in performance and pressure development
- Designed for handling air within 'space critical' equipment
- Tachometer output 0-10V
- Temperature up to 40°C
- EC motor variable speed control via voltage 0-10V Input
- Range of EC single fans - ex-stock

EC Single Inlet Fans

A range of compact high efficiency driven EC fans that achieve from 83 l/s to 115 l/s and fully comply to the minimum efficiency regulation rates of ErP 327/2011 – 2013 and 2015. The fans incorporate integrated EC type motors with tablock constructed forward curved impellers dynamically balanced to grade 2.5 DIN ISO 1940. Constructed from mild steel with a robust paint finish, each fan casing is fitted with an outlet flange

incorporating fixing holes for ease of installation. Simply choose a compliant EC fan for your new high efficiency application.

OEM variants are available on request. Please apply to customer services for non-standard design (minimum order quantities will apply).



APPLICATIONS

- Compact cooling in electronics / server cabinets
- Lighting and cinema equipment
- Smaller air conveying systems
- Fume cupboards

* Note - Fans not suitable for EEXE, EEXD, ATEX or corrosive atmospheres

- Museum interactive displays
- Plastic manufacturing extrusions
- Any application demanding 'space critical' air movement

SPECIFICATIONS

The fans in this range are eminently suitable for speed control via voltage variation 0-10V input and come supplied with direct flying lead 230V and 0-10V connection to the motor. Very low maintenance achieved by use of sealed

for life bearings in the EC motors, typically offering bearing life L10. 25,000 hours in ideal conditions and can be universally mounted via flange. Test data in accordance with BS 848 Part1/ ISO 5801-2007.

TECHNICAL DATA

Fan Model	Supply voltage	Frequency	Control voltage	Speed at Max input watts	Max input watts	Noise level	Min static pressure	Max air flow	Weight	Max ambient temp	IP	ErP 2013/2015
	Volts	Hz	Volts	Rpm	W	dBA*	Pascal	L/S	kg	°C		
SIEC 120x x 62	230	50 / 60	0-10	2800	55	58	0	78	2.1	40	IP 24	✓
SIEC 133x x 46	230	50 / 60	0-10	2200	75	54	0	90	2.2	40	IP 24	✓
SIEC 160x x 62	230	50 / 60	0-10	1310	80	58	0	115	3.2	40	IP 24	✓

DIMENSIONS

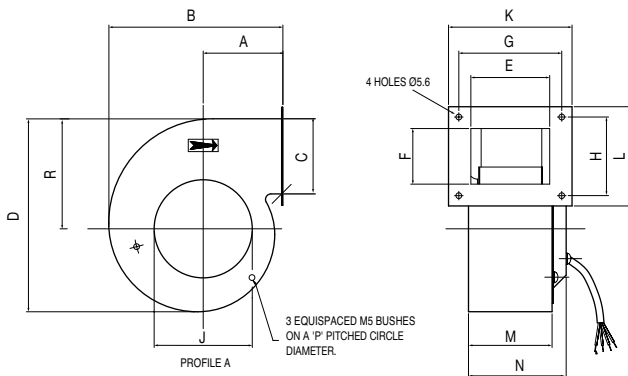

Fan Model	Stock No.	A	B	C	D	E	F	G	H	J	K	L	M	N	P	R
120 x 62 L2	9000365	78	174	75	192	82	75	100	92	94	120	112	85	127	134	107
133 x 46 L2	9000366	81	197	92	230	73	92	85	110	108	105	130	75	115	146	119
160 x 62 L2	9000367	104	231	97	268	83	97	100	112	138	120	132	86	127	168	142

Dimensions are for guidance only - certified drawings available

PERFORMANCE

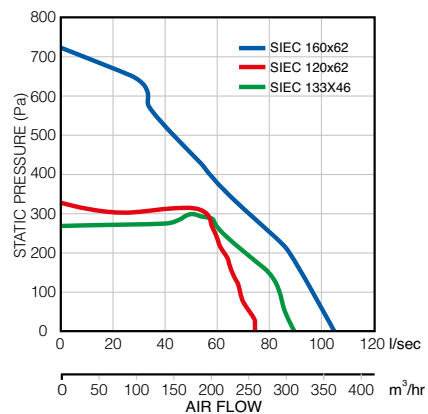

Call: 01494 560800

Visit: airflow.com



Airflow Developments Limited
Aidelle House, Lancaster Road,
Cressex Business Park,
High Wycombe, Buckinghamshire,
United Kingdom, HP12 3QP

E-mail: info@airflow.com
Telephone: +44 (0) 1494 525252

airflow.com

© Airflow Developments Limited. Airflow Developments Limited reserve the right, in the interests of continuous development, to alter specifications without prior notice. All orders are accepted subject to our conditions of sale which are available on request



80000693 Issue 1 06/07